



# Stereo Headphones

Operating Instructions  
使用説明書  
사용설명서

## MDR-EX1000

©2010 Sony Corporation Printed in Japan

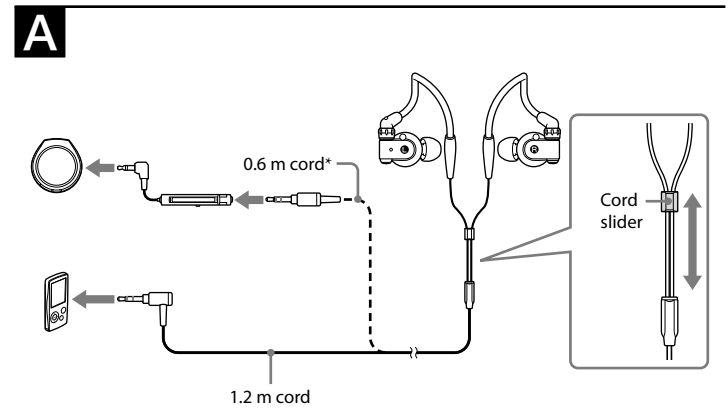

\* You can replace the cord according to the connecting device. See "Replacing the cord."

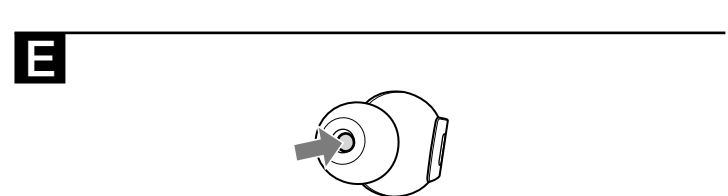
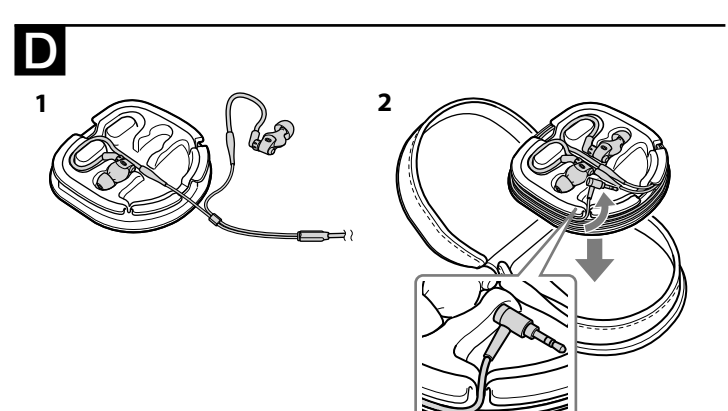
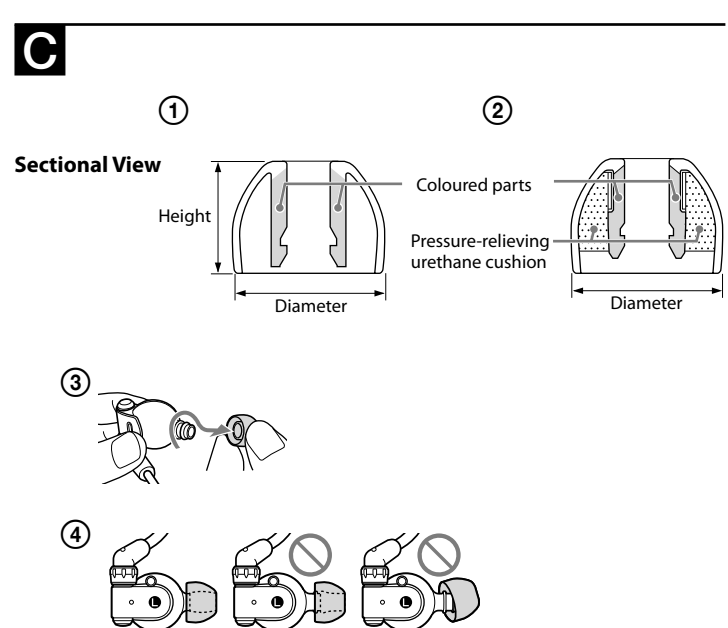
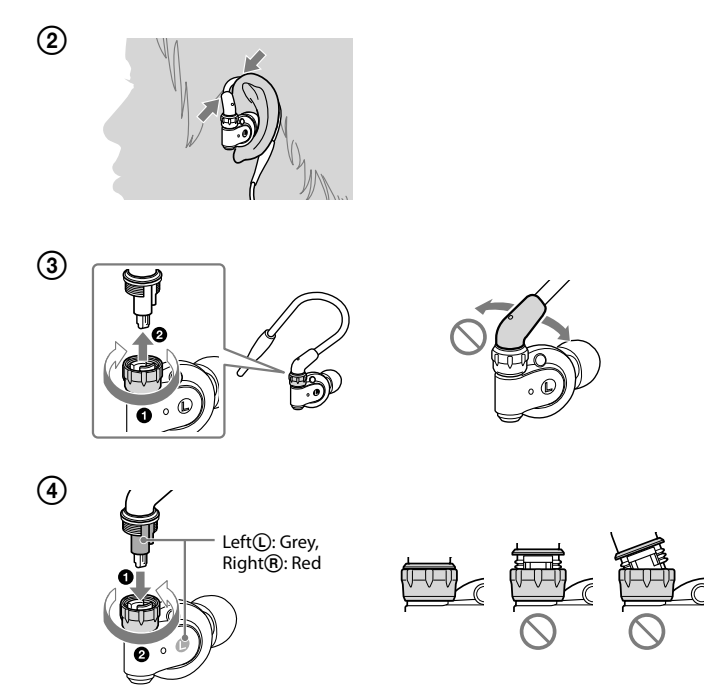
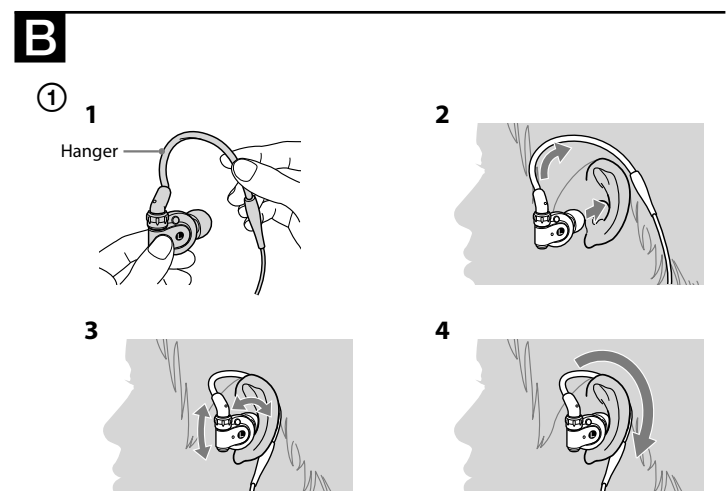

## English

### Stereo headphones

### Features

- 16 mm dynamic type driver units deliver a wide frequency range and broader dynamic range, and reproduce accurate sound
- Driver unit's diaphragm utilizing Liquid Crystal Polymer Film for highly accurate sound
- Thin and lightweight magnesium alloy housing to prevent unnecessary vibration for smooth bass response and clear mid-high range sound
- 7N-OFC, Oxygen Free Copper with super high-purity (99.99999%), is used for the core of the cord to minimize signal transmission loss
- Acoustically adjusted by hand
- Secure fitting with flexible hanger
- Closed type vertical in-the-ear headphones for wearing comfort
- 7 sizes of hybrid silicone rubber earbuds for secure fit and long-term wearing comfort (SS, S, MS, M, ML, L, LL)  
3 sizes of noise isolation earbuds for effective attenuation of ambient noise (S, M, L)
- Detachable cord (1.2 m/0.6 m)
- Genuine leather carrying case supplied

### How to use

#### Using the cord slider (see fig. A)

Move up and down to change the split position of the cord.

#### Wearing the headphones (see fig. B-①)

Wear the earpiece marked **Ⓡ** in your right ear and the one marked **Ⓛ** in your left ear. There is a tactile dot on the unit marked **Ⓛ** to distinguish the left side.

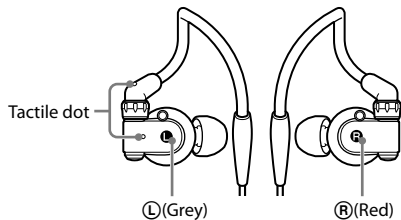

- 1 Hold the headphone as in the illustration, and curve the hanger into an ear shape.
- 2 Wear the headphone placing the hanger behind the ear.
- 3 Adjust the angle of the headphone to fit snugly.
- 4 Adjust the hanger to fit behind the ear.

#### Tip

As in the illustration, tuck the hanger and headphone toward the base of your ear to stabilize the headphone (see fig. B-②).

### Replacing the cord

#### To detach the cord (see fig. B-③)

Loosen the screw collar of each headphone and remove both cords.

#### Note

Do not twist the base of the hanger, or it may break.

#### To attach the cord (see fig. B-④)

Determine the right/left of the cord and headphones by checking the colour of the cord jack and the **Ⓛ**/**Ⓡ** marks of the headphones, then insert each cord jack and tighten the screw collar.

#### Note

Do not tighten the screw collar with the cord at an angle, or it may break.

### Installing the earbuds correctly (see fig. C)

If the earbuds do not fit your ears correctly, low-bass sound may not be heard. To enjoy better sound quality, change the earbuds to another size or type, or adjust the earbuds position to sit on your ears comfortably and fit your ears snugly. If the earbuds do not fit your ears, try another size or type. Confirm the size of the earbuds by checking the colour inside (see fig. C-①) for hybrid silicone rubber earbuds and C-② for noise isolation earbuds).

When you change the earbuds, install them firmly on the headphones to prevent the earbud from detaching and remaining in your ear.

#### About hybrid silicone rubber earbuds (see fig. C-①)

##### Earbud sizes (inside colour)

	Small ←	Diameter	→ Large
High	–	ML (Blue)	LL (Purple)
Height	S (Orange)	M (Green)	L (Light blue)
Low	SS (Red)	MS (Yellow)	–

#### To clean the hybrid silicone rubber earbuds

Remove the earbuds from the headphones, and wash them with a mild detergent solution.

#### About noise isolation earbuds (see fig. C-②)

Supplied noise isolation earbuds provides a snug fit for effective attenuation of ambient noise.

##### Earbud sizes (inside colour)

Small ←	Diameter	→ Large
S (Orange)	M (Green)	L (Light blue)

#### Notes

- Prolonged use of the noise isolation earbuds may strain your ears due to their snug fit. If you have experience discomfort or pain in your ears, discontinue use.
- The pressure-relieving urethane cushion is extremely soft. Therefore, do not pinch or pull the urethane cushion. If the urethane cushion is broken or detached from the earbuds, it will not take its correct position and the earbuds will lose their noise isolation function.
- The pressure-relieving urethane cushion may deteriorate due to long-term storage or use. If the pressure-relieving urethane cushion is lost and the urethane cushion becomes hard, the earbuds may lose their noise isolation function.
- Do not wash the noise isolation earbuds. Keep them dry, and avoid accumulation of water in the pressure-relieving urethane-cushions. Not doing so may cause early deterioration.

#### To detach an earbud (see fig. C-③)

While holding the headphone, twist the parts inside of the earbud and pull the earbud off.

#### Tip

If the earbud slips and cannot be detached, wrap it in a dry soft cloth.

#### To attach an earbud (see fig. C-④)

Push the parts inside of the earbud into the headphone until the projecting part of the headphone is fully covered.

### Carrying the headphones (see fig. D)

Bundle the cord first by using cord slider.

- 1 Place the headphones in the inner case.
- 2 Wind the cord around the side of the inner case and store the plug, and then put the inner case in the carrying case.

#### Notes

- Do not close the case forcibly without winding up the cord. Otherwise, the cord may break.
- Caution regarding the carrying case
  - The carrying case is made of natural materials and its colour may fade due to hair dressing or skin oil, and could also cause stains to other materials. Also, the pattern and colour of the leather may vary.
  - Do not use alcohol, benzene, or thinner, as the carrying case may be damaged.
  - Wipe the carrying case with a dry towel if it becomes wet, otherwise it may discolour.
  - Do not leave the carrying case in a location subject to direct sunlight, such as in a car.

### Specifications

- Type:** Closed, dynamic
- Driver unit:** 16 mm, dome type (CCAW)
- Power handling capacity:** 200 mW (IEC\*)
- Impedance:** 32 Ω at 1 kHz
- Sensitivity:** 108 dB/mW
- Frequency response:** 3 Hz – 30,000 Hz
- Cord:** 1.2 m (47 1/4 in)/0.6 m (23 5/8 in) (7N-OFC Litz cord adopted, Y-type, detachable)
- Plug:** Gold-plated L-shaped stereo mini plug (1.2 m cord) / Gold-plated stereo mini plug (0.6 m cord)
- Mass:** Approx. 8 g (0.29 oz) (without cord)

#### Supplied accessories

Carrying case (1) / 1.2 m cord (RK-EX1000LP, 1) / 0.6 m cord (RK-EX1000SP, 1) / Hybrid silicone rubber earbuds (SS (2), S (2), MS (2), M (2), ML (2), L (2), LL (2)) / Noise isolation earbuds (S (2), M (2), L (2)) / Operating Instructions (1) / Product Information (1)

\* IEC = International Electrotechnical Commission  
Design and specifications are subject to change without notice.

### Precautions

- Please keep your headphones clean at all times especially inside the rubber earbud (see fig. E).
- If any dust or ear wax is inside the earbud, you may experience some listening difficulties.
- Listening with headphones at high volume may affect your hearing. For traffic safety, do not use while driving or cycling.
- Handle the driver units carefully.
- Do not put weight or pressure on the headphones as it may cause the headphones to deform during long storage.
- The earbuds may deteriorate due to long-term storage or use.
- Install the earbuds firmly onto the headphones. If an earbud accidentally detaches and is left in your ear, it may cause injury.
- Do not pull the hanger or cord too hard.
- Store the earbuds where children cannot reach in order to prevent from accidental ingestion or choking.

#### Note on static electricity

In particularly dry air conditions, mild tingling may be felt on your ears. This is a result of static electricity accumulated in the body, and not a malfunction of the headphones. The effect can be minimized by wearing clothes made from natural materials.

You can order optional replacement earbuds and cord (RK-EX1000LP or RK-EX1000SP) at your nearest Sony dealer.

